

1 PERSPECTIVE

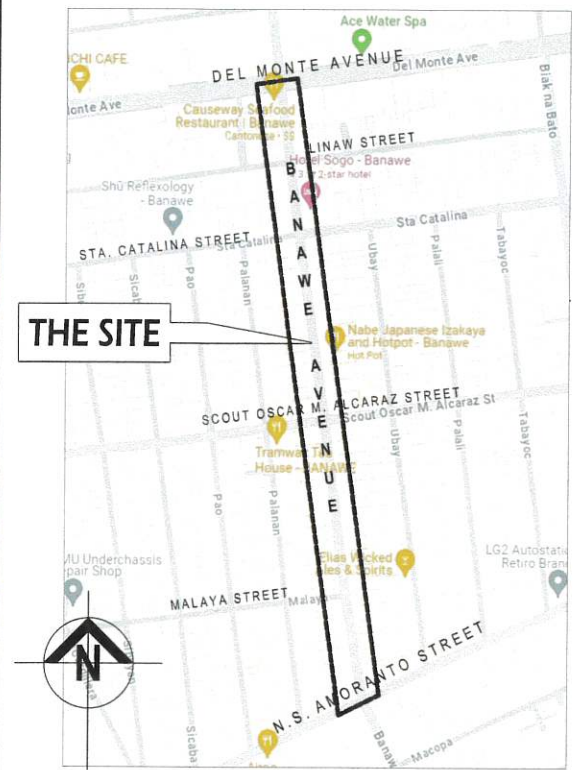

2 KEY MAP

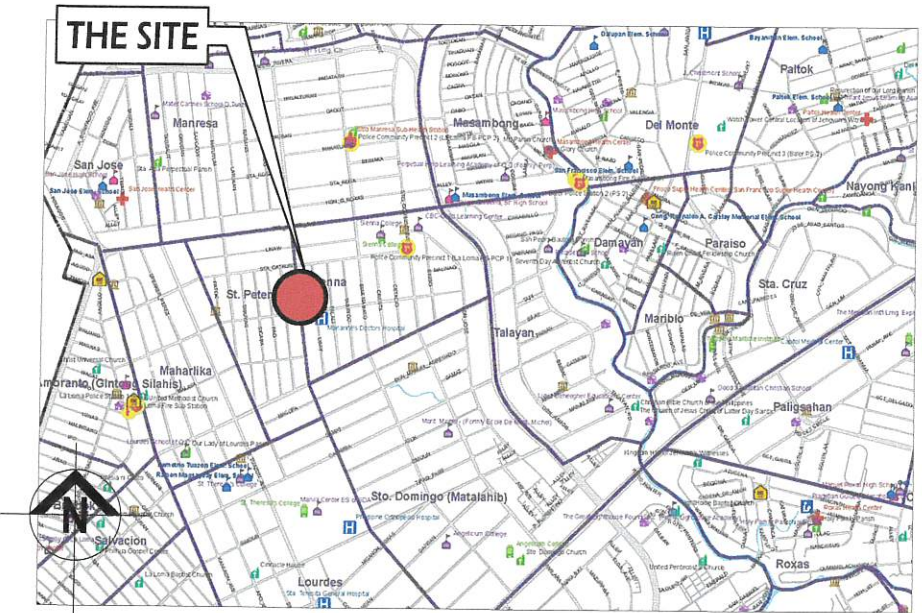

3 VICINITY MAP

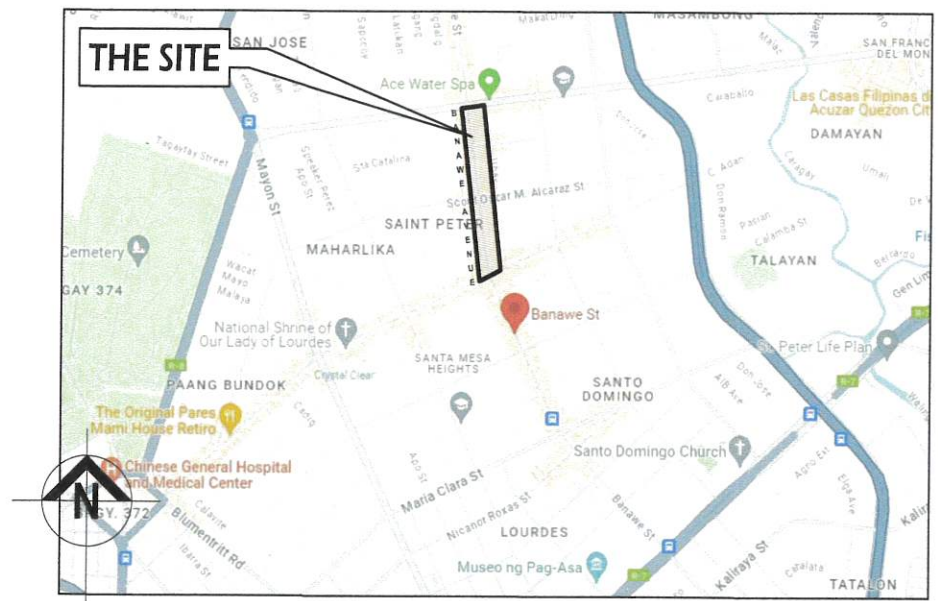

4 LOCATION MAP

<p>Republika ng Pilipinas Lungsod ng Quezon <b>CITY ARCHITECT DEPARTMENT</b> 5F CIVIC CENTER - D (BRO. Bldg), QUEZON CITY HALL COMPOUND, ELLIPTICAL ROAD, DILIMAN, QUEZON CITY</p>	<p>PROVISO: DRAWINGS AND SPECIFICATIONS ONLY SIGNED, STAMPED OR SEALED AS INSTRUMENTS OF SERVICE ARE THE PROPERTY OF THE CITY ARCHITECT DEPARTMENT. WHETHER THE SUBJECT FOR WHICH THEY ARE MADE IS REGISTERED OR NOT, IT SHALL BE VALID FOR ANY PERSON, WITHOUT THE CONSENT OF THE ARCHITECT, TO DUPLICATE OR TO MAKE COPIES OF SAID DOCUMENTS FOR USE IN THE EXECUTION OF ANY OF OTHER PROJECTS OR BUILDINGS, WHETHER REGISTERED OR NOT.</p>	<p>RECOMMENDING APPROVAL</p> <p><b>AR. LUCILLE H. CHUA, fuap, piep</b> CITY ARCHITECT</p>	<p>APPROVED BY:</p> <p><b>HON. MA. JOSEFINA G. BELMONTE</b> MAYOR</p>	<p>PROJECT TITLE:</p> <p><b>SUPPLY &amp; INSTALLATION OF CHINESE ORNAMENTS AT BANAWA AVENUE</b></p> <p>LOCATION : BARANGAY SIENNA, QUEZON CITY</p>	<p>SHEET CONTENTS:</p> <p>PERSPECTIVE KEY MAP VICINITY MAP LOCATION MAP</p>	<p>PROJECT NO.:</p> <p>DATE: January 2024 DRAWN BY: Ar. R.B.C / Ar. M.K.K.A. DESIGNED BY: Ar. A.C.S.B / Ar. M.L.T.J.L. CHECKED BY: Ar. V.G.L / Ar. G.T.G.</p>	<p>SHEET NO.:</p> <p><b>AR-01</b></p>

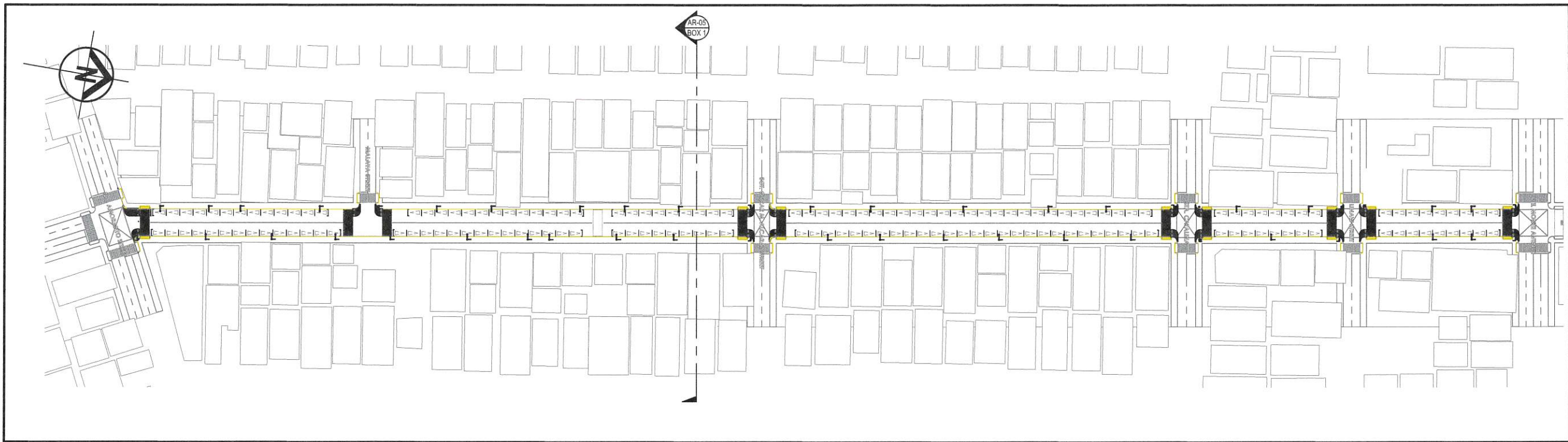

**1 BANAWE STREET SEGMENT 1 PLAN ( N.S AMORANTO Sr. STREET TO DEL MONTE AVENUE )**

SCALE 1:1000 METERS

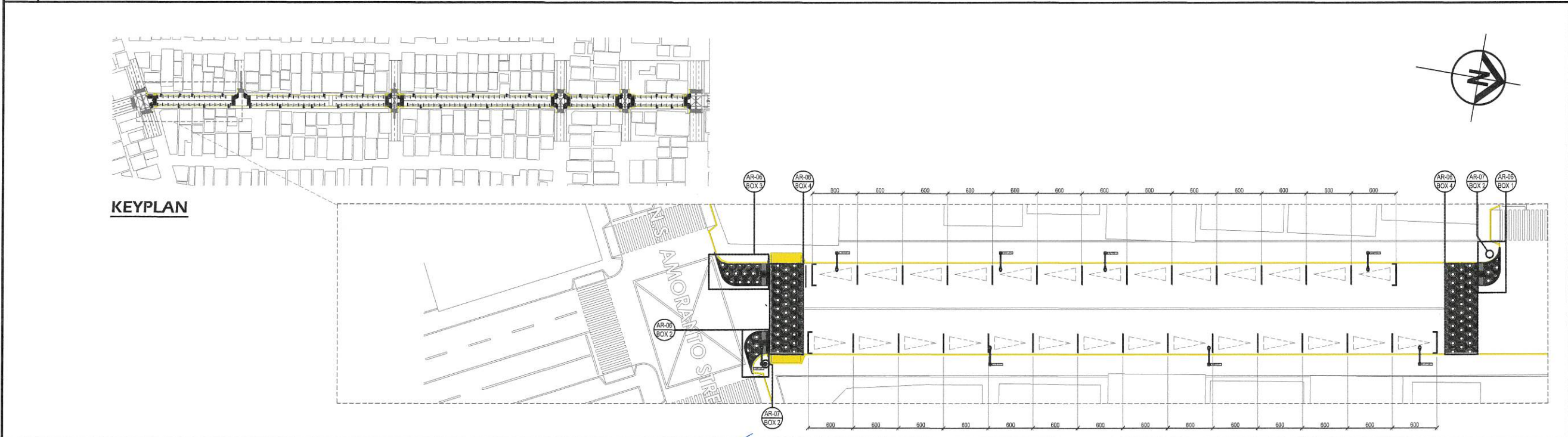

**KEYPLAN**

**2 BANAWE STREET BLOW-UP PLAN ( N.S AMORANTO Sr. STREET TO MALAYA STREET )**

SCALE 1:300 METERS

<p>Republika ng Pilipinas Lungsod ng Quezon <b>CITY ARCHITECT DEPARTMENT</b> 5F CIVIC CENTER - D (BRO. Bldg), QUEZON CITY HALL COMPOUND, ELLIPTICAL ROAD, DILIMAN, QUEZON CITY</p>	<p><b>PROVISO:</b> DRAWING AND SPECIFICATIONS DULY SIGNED, STAMPED OR SEALED AS INSTRUMENTS OF SERVICE ARE THE INTELLECTUAL PROPERTY &amp; DOCUMENTS OF THE CITY ARCHITECT DEPARTMENT. WHETHER THE OBJECT FOR WHICH THEY ARE MADE IS EXECUTED OR NOT, IT SHALL BE UNLAWFUL FOR ANY PERSON, WITHOUT THE CONSENT OF THE AUTHOR OF SAID DOCUMENTS TO DUPLICATE OR TO MAKE COPIES OF SAID DOCUMENTS FOR USE IN THE REPRODUCTION OF ANY OTHER PROJECTS OR BUILDINGS, WHETHER EXECUTED PARTLY OR IN WHOLE.</p>	<p>RECOMMENDING APPROVAL</p> <p><b>AR. LUCILLE H. CHUA, fuap, piep</b> CITY ARCHITECT</p>	<p>APPROVED BY:</p> <p><b>HON. MA. JOSEFINA G. BELMONTE</b> MAYOR</p>	<p>PROJECT TITLE :</p> <p><b>SUPPLY &amp; INSTALLATION OF CHINESE ORNAMENTS AT BANAWE AVENUE</b></p> <p>LOCATION : BARANGAY SIENNA, QUEZON CITY</p>	<p>SHEET CONTENTS :</p> <p><b>BANAWE STREET SEGMENT 1 PLAN ( NS AMORANTO SR. STREET TO DEL MONTE AVENUE )</b> <b>BANAWE STREET PLAN ( NS AMORANTO SR. STREET TO MALAYA STREET )</b></p>	<p>PROJECT NO.:</p>	<p>SHEET NO.:</p> <p><b>AR-02</b></p>

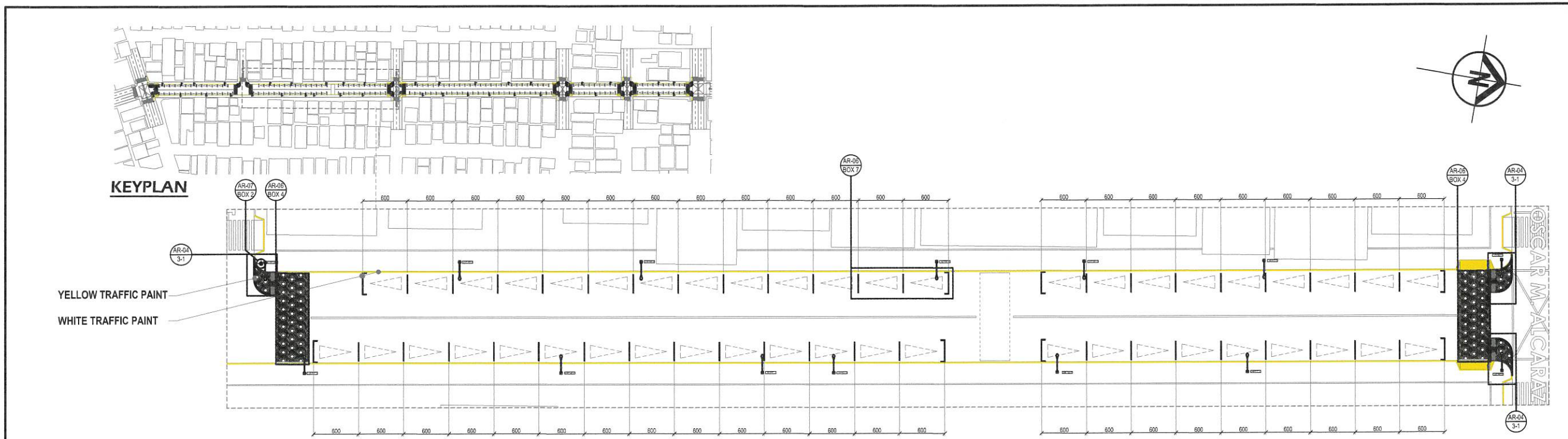



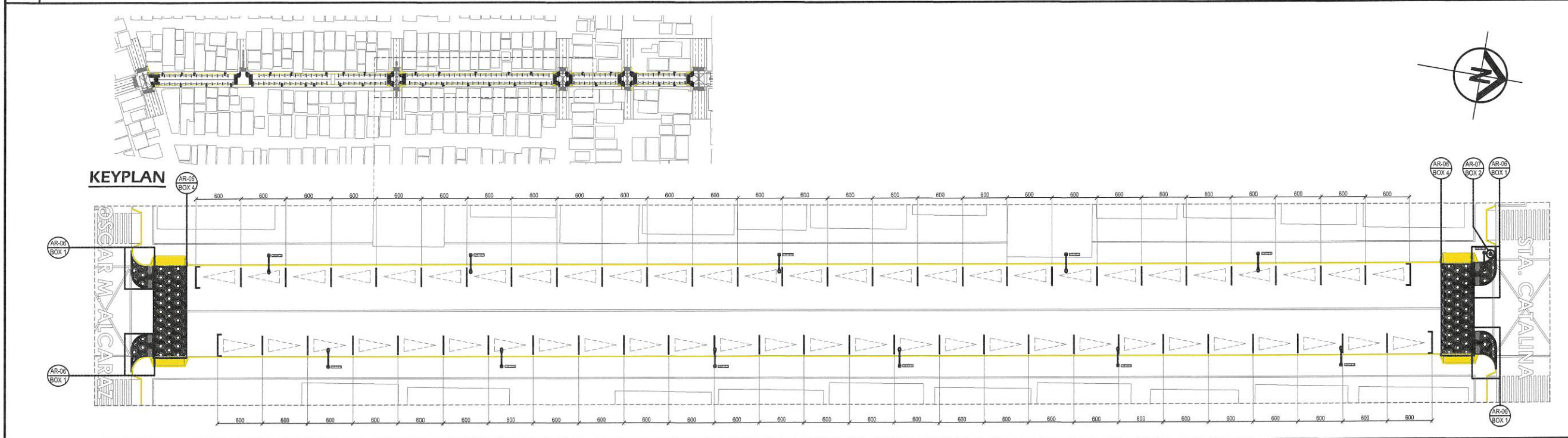

**1 BANAWE STREET BLOW-UP PLAN ( MALAYA STREET TO SCOUT OSCAR M. ALCARAZ STREET )**

SCALE 1:300 METERS



**2 BANAWE STREET BLOW-UP PLAN ( SCOUT OSCAR M. ALCARAZ STREET TO STA. CATALINA )**

SCALE 1:300 METERS

 <p>Republika ng Pilipinas Lungsod ng Quezon <b>CITY ARCHITECT DEPARTMENT</b> 5F CIVIC CENTER - D (BRO. Bldg), QUEZON CITY HALL COMPOUND, ELLIPTICAL ROAD, DILIMAN, QUEZON CITY</p>	 <p><b>PROVISO:</b> DRAWING AND SPECIFICATIONS SHALL BE MADE IN PEN OR BEGAS AS INSTRUMENTS OF SERVICE ARE THE INSTRUMENTS OF SERVICE AND DOCUMENTS OF THE CITY ARCHITECT DEPARTMENT. WHENEVER THE CLIENT FOR WHICH THEY ARE MADE IS REQUESTED OR NOT, IT SHALL BE HELD RESPONSIBLE FOR ANY PERSON, WITHOUT THE CONSENT OF THE ARCHITECT, TO MAKE COPIES OF SAID DOCUMENTS FOR USE IN THE EXECUTION OF ANY OTHER PROJECTS OR BUILDINGS, WHETHER EXECUTED BY SAID CLIENT OR NOT.</p>	<p>RECOMMENDING APPROVAL</p>  <p><b>AR. LUCILLE H. CHUA, fuap, piep</b> CITY ARCHITECT</p>	<p>APPROVED BY:</p>  <p><b>HON. MA. JOSEFINA G. BELMONTE</b> MAYOR</p>	<p>PROJECT TITLE:</p> <p><b>SUPPLY &amp; INSTALLATION OF CHINESE ORNAMENTS AT BANAWE AVENUE</b></p> <p>LOCATION: BARANGAY SIENNA, QUEZON CITY</p>	<p>SHEET CONTENTS:</p> <p>BANAWE STREET PLAN (MALAYA STREET TO SCOUT OSCAR M. ALCARAZ STREET)</p> <p>BANAWE STREET PLAN (SCOUT OSCAR M. ALCARAZ STREET TO STA. CATALINA)</p>	<p>PROJECT NO.:</p> <p>DATE: January 2024</p> <p>DRAWN BY: Ar. R.B.C / Ar. M.K.K.A</p> <p>DESIGNED BY: Ar. A.C.S.B / Ar. M.L.T.D.L</p> <p>CHECKED BY: Ar. V.C.L / Ar. G.T.Q</p>	<p>SHEET NO.:</p> <p><b>AR-03</b></p>
		<p>Ar. V.C.L / Ar. G.T.Q</p>					

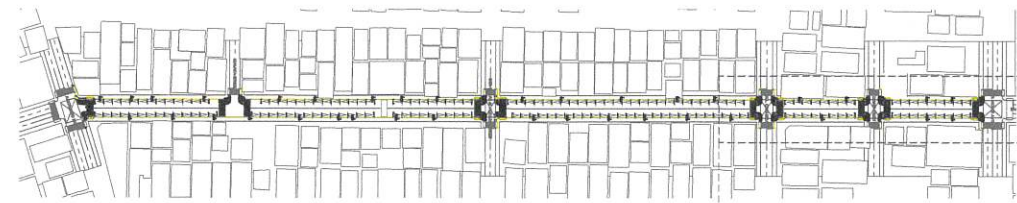

**KEYPLAN**

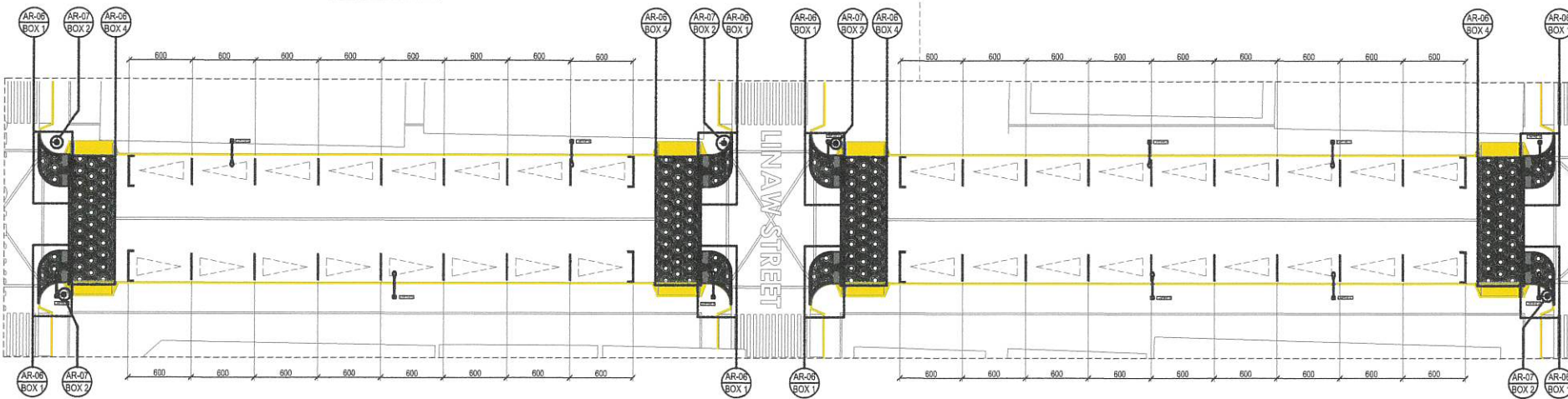

**1 BANAWE STREET BLOW-UP PLAN ( STA. CATALINA TO DEL MONTE AVENUE )**

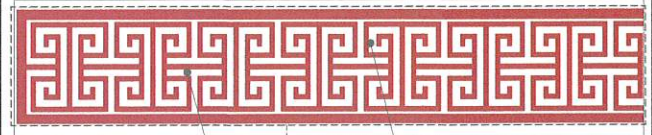

CHINESE-INSPIRED PATTERN DESIGN IN PAINT FINISH

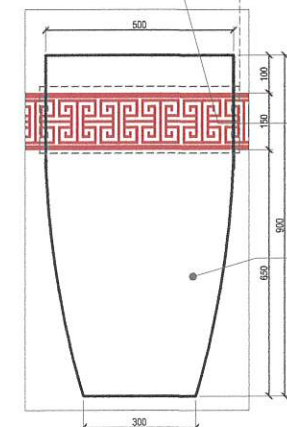

**SIDE VIEW**

CONCRETE POT PAINTED FINISH (SUBMIT SAMPLE FOR ARCHITECT'S APPROVAL)

CONCRETE POT PAINTED FINISH (SUBMIT SAMPLE FOR ARCHITECT'S APPROVAL)

**3 CONCRETE POT DETAIL** SCALE 1:1000

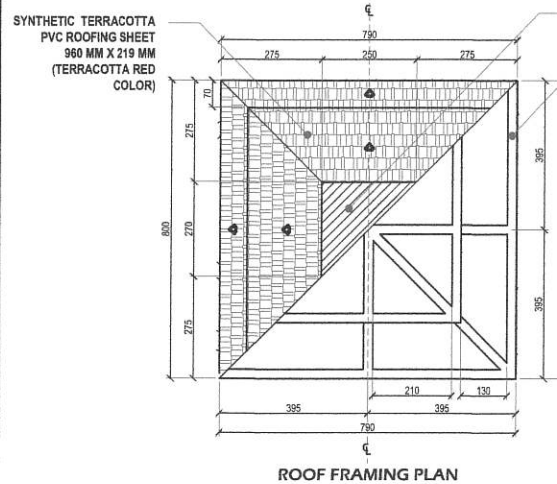

**ROOF FRAMING PLAN**

20X20 SOLAR PANEL W/LIGHT PHOTO SENSOR SWITCH

1 X 1" ROOF FRAMING ON ANGULAR STEEL BARS

3 MM CUSTOM METAL CUT SHEET WELDED IN ANGULAR STEEL BARS

VERTICAL, HORIZONTAL AND DIAGONAL 2 X 2" TUBULAR STEEL FRAME, BLACK ENAMEL PAINTED FINISH

3 X 6" TUBULAR STEEL FRAME SEMI-GLOSS YELLOW ENAMEL PAINTED FINISH

VERTICAL, HORIZONTAL AND DIAGONAL 2 X 2" TUBULAR STEEL FRAME, BLACK ENAMEL PAINTED FINISH

1 1/2 X 1" TUBULAR STEEL FRAME SEMI-GLOSS YELLOW ENAMEL PAINTED FINISH (TOP BASE)

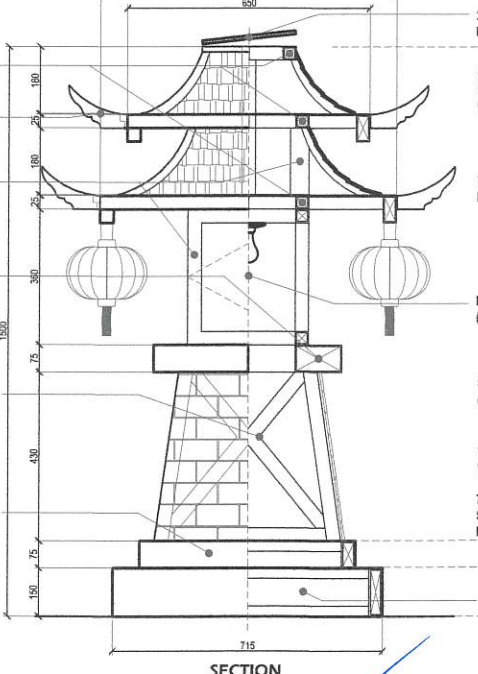

**SECTION**

20X20 SOLAR PANEL W/LIGHT PHOTO SENSOR SWITCH

SYNTHETIC TERRACOTTA PVC ROOFING SHEET 960 MM X 219 MM (TERRACOTTA RED COLOR)

YELLOW SEMI-GLOSS ENAMEL PAINT WITH METAL PRIMER

MAINTENANCE DOOR (WHITE ARCLIC)

SYNTHETIC PVC BRICKS SHEET 960 MM X 219 MM (TERRACOTTA RED COLOR)

YELLOW SEMI-GLOSS ENAMEL PAINT WITH METAL PRIMER

700 MM X 700 MM BASE TUBULAR FRAMING SEMI-GLOSS YELLOW ENAMEL PAINT WITH METAL PRIMER

2 X 6" TUBULAR STEEL FRAME SEMI-GLOSS BLACK ENAMEL PAINTED FINISH (BOTTOM BASE)

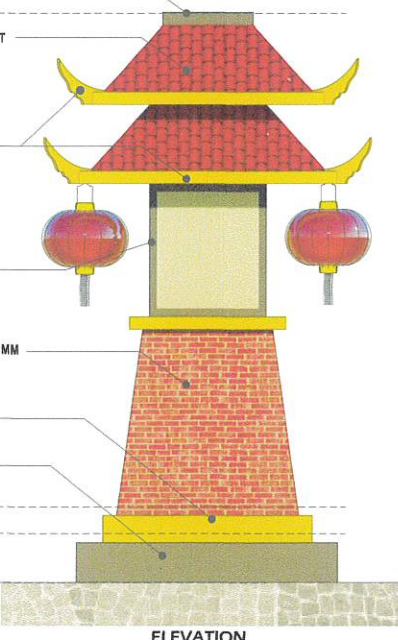

**ELEVATION**

**2 PAGODA DETAILS**

**CHINESE ORNAMENTS OF BANAWE CHINATOWN FROM N.S AMORANTO TO DEL MONTE AVENUE**

OPTION 1 - ITEM	QTY	UNIT
EXISTING POST	46	PCS
ONION LANTERNS (DOUBLE)	46	PCS
BANNERS	46	PCS
LIGHTED DRAGON LANTERN	46	PCS
PAINTED PEDESTRIAN CROSSING	10	PCS
MODULAR PAGODA	18	PCS
PLANT TOPS	72	PCS
SIDEWALK CORNER EXTENSION - 1 (TYPICAL)	16	PCS
SIDEWALK CORNER EXTENSION - 2 (NS. AMORANTO)	1	PCS
SIDEWALK CORNER EXTENSION - 3 (NS. AMORANTO)	1	PCS
PARALLEL PARKING SLOT	162	SLOT
YELLOW TRAFFIC PAINT	279	SQM
WHITE TRAFFIC PAINT	38	SQM
RED AND YELLOW THERMOPLASTIC PAINT	590	SQM
OPTION 2 - ITEM	QTY	UNIT
EXISTING POST	46	PCS
ONION LANTERNS (DOUBLE)	46	PCS
BANNERS	46	PCS
DRAGON METAL LASER CUT	46	PCS
PAINTED PEDESTRIAN CROSSING	10	PCS
MODULAR PAGODA	18	PCS
PLANT TOPS	72	PCS
SIDEWALK CORNER EXTENSION - 1 (TYPICAL)	16	PCS
SIDEWALK CORNER EXTENSION - 2 (NS. AMORANTO)	1	PCS
SIDEWALK CORNER EXTENSION - 3 (NS. AMORANTO)	1	PCS
PARALLEL PARKING SLOT	162	SLOT
YELLOW TRAFFIC PAINT	279	SQM
WHITE TRAFFIC PAINT	38	SQM
RED AND YELLOW THERMOPLASTIC PAINT	590	SQM

**4 SCHEDULE OF DECORS**

<p>Republika ng Pilipinas Lungsod ng Quezon <b>CITY ARCHITECT DEPARTMENT</b> 5F CIVIC CENTER - D (BRD, 3rd Fl), QUEZON CITY HALL COMPOUND, ELLIPTICAL ROAD, DILIMAN, QUEZON CITY</p>	<p>PROVISO:</p> <p>DRAWING AND SPECIFICATIONS ONLY. DRAWING, AS APPLIED OR REFERRED TO INSTRUMENTS OF SERVICE ARE THE INTELLECTUAL PROPERTY OF THE CITY ARCHITECT DEPARTMENT. WHETHER THE OBJECT FOR WHICH THEY ARE MADE IS EXISTING OR NOT, IT SHALL BE SUBJECT TO ANY FUTURE, WITHOUT THE CONSENT OF THE AUTHOR OF SAID DOCUMENTS TO REPRODUCE OR IN ANY MANNER TO BE USED FOR OTHER PROJECTS OR BUILDINGS, WHETHER REGISTERED OR NOT, IN WHOLE OR IN PART.</p>	<p>RECOMMENDING APPROVAL</p> <p><i>Lucille H. Chua</i> <b>AR. LUCILLE H. CHUA, fuap, piep</b> CITY ARCHITECT</p>	<p>APPROVED BY:</p> <p><i>Hon. Ma. Josefina G. Belmonte</i> <b>HON. MA. JOSEFINA G. BELMONTE</b> MAYOR</p>	<p>PROJECT TITLE:</p> <p><b>SUPPLY &amp; INSTALLATION OF CHINESE ORNAMENTS AT BANAWE AVENUE</b></p> <p>LOCATION: BARANGAY SIENNA, QUEZON CITY</p>	<p>SHEET CONTENTS:</p> <p>BANAWE STREET PLAN (SCOUT OSCAR M. ALCARAZ STREET TO DEL MONTE AVENUE) PAGODA DETAILS SCHEDULE OF DECORS CONCRETE POT DETAILS PAGODA DETAILS SCHEDULE OF DECOR</p>	<p>PROJECT NO.:</p> <p>DATE: January 2024 DRAWN BY: Ar. R.B.C / Ar. M.K.K.A. DESIGNED BY: Ar. A.C.S.B / Ar. M.L.T.D.L. CHECKED BY: Ar. X.G.L / Ar. G.T.Q.</p>	<p>SHEET NO.:</p> <p><b>AR-04</b></p>
	<p>REPUBLIC OF THE PHILIPPINES</p>						

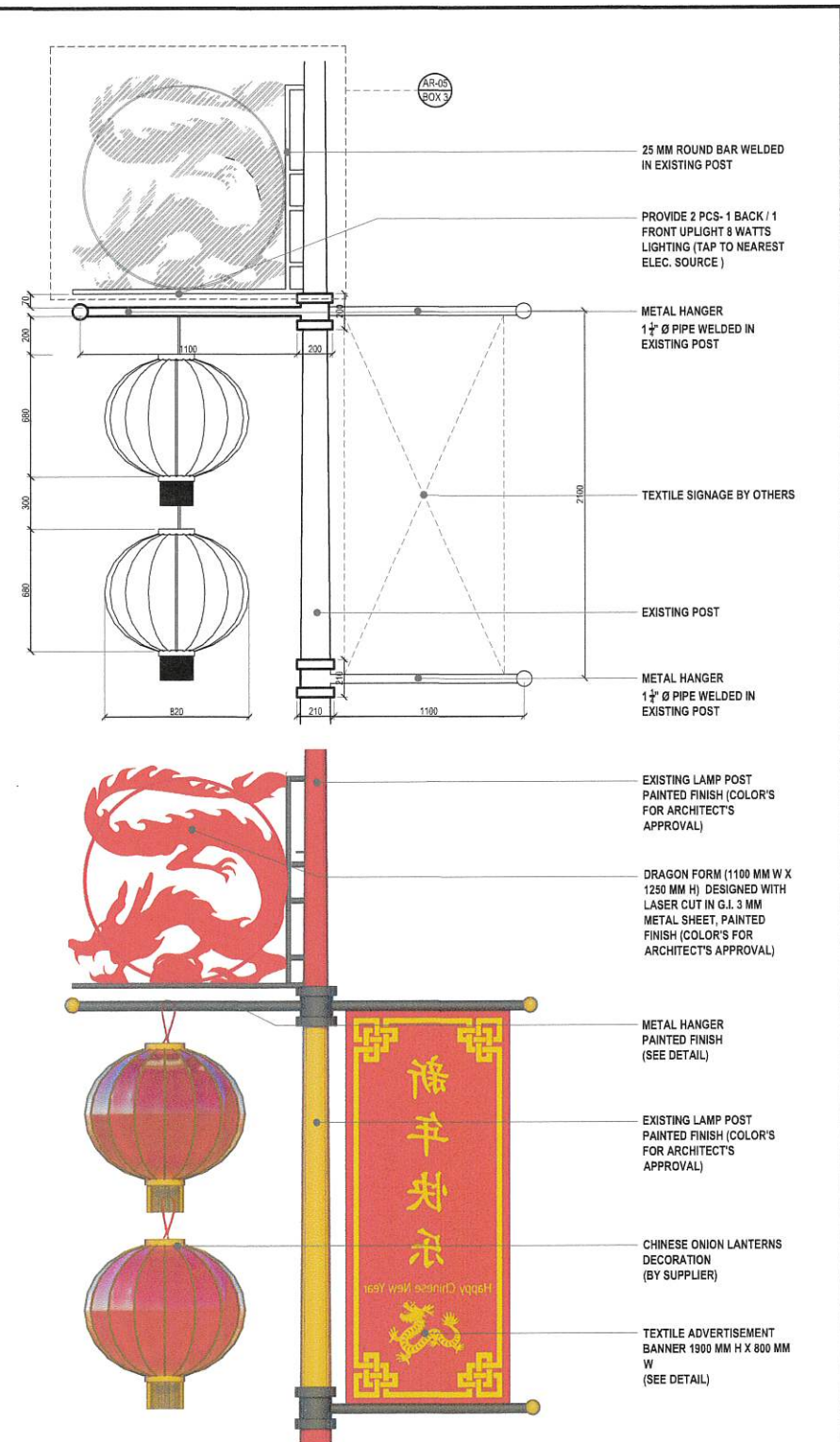
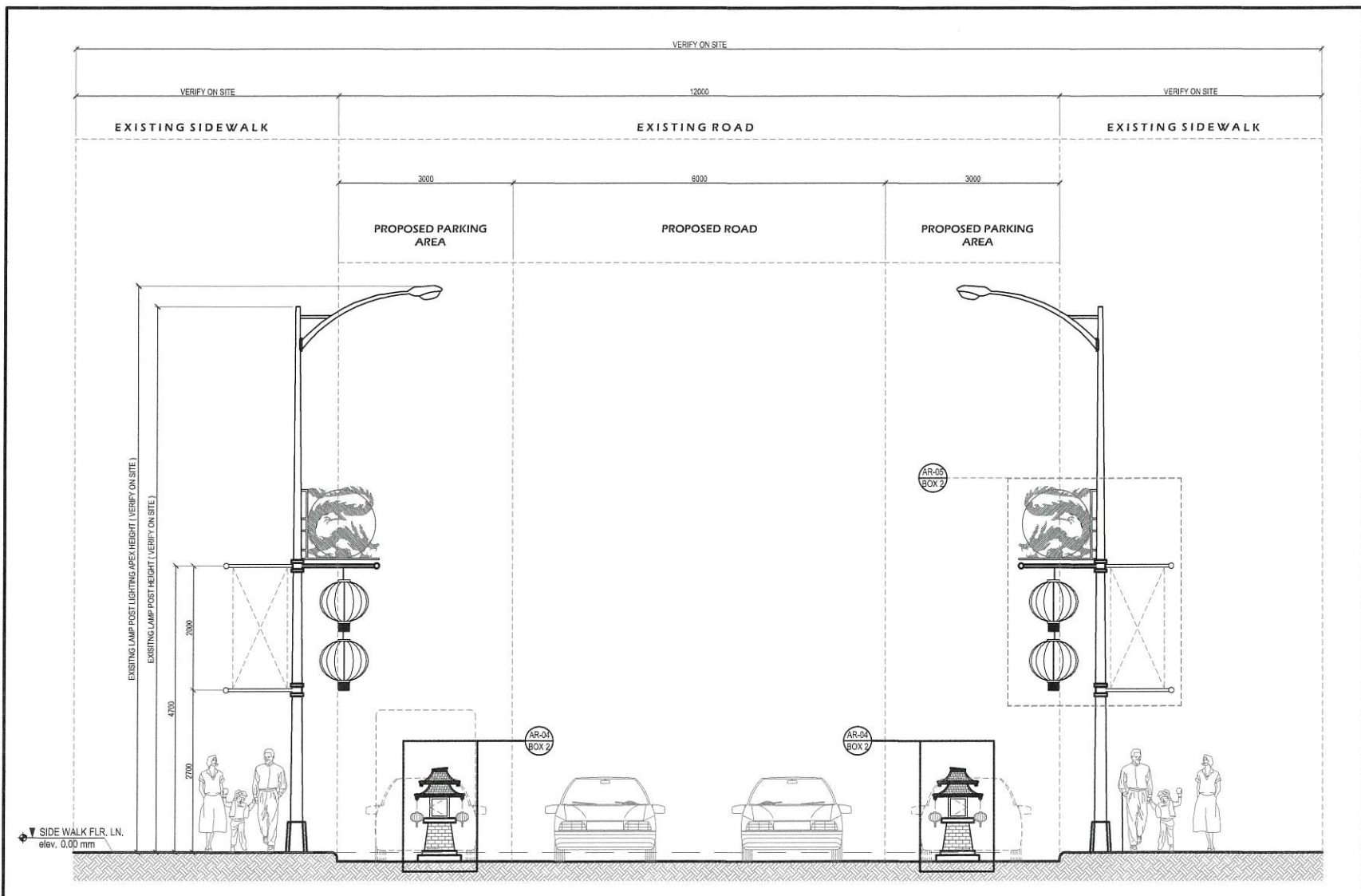

**1 LAMP POST DETAIL** SCALE 1:50 METERS

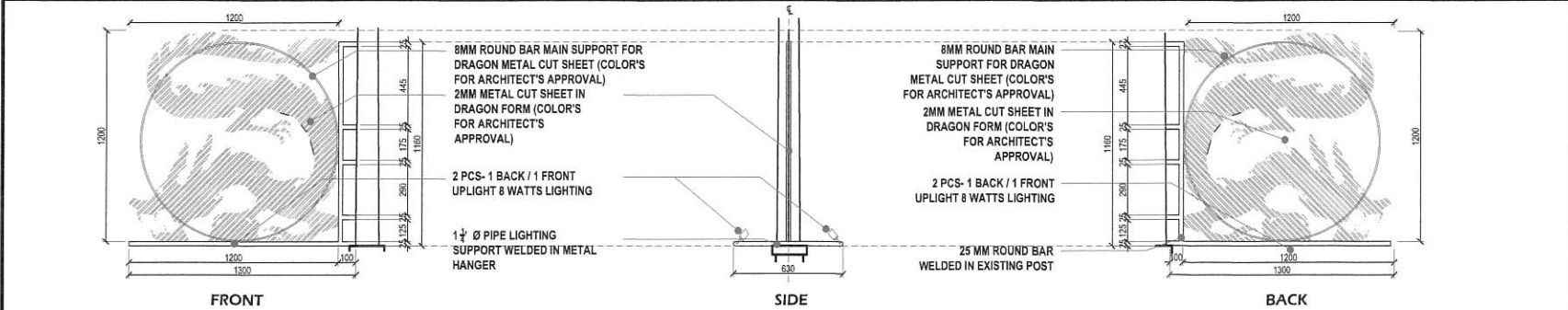

**3 DRAGON METAL SHEET** SCALE 1:20 METERS

**2 DECOR DETAILS** SCALE 1:20 METERS

<p>Republika ng Pilipinas Lungsod ng Quezon <b>CITY ARCHITECT DEPARTMENT</b> 5F CIVIC CENTER - D (Bldg. 503), QUEZON CITY HALL COMPOUND, ELLIPTICAL ROAD, DILIMAN, QUEZON CITY</p>	<p>PROVISO: DRAWING AND SPECIFICATIONS MUST BE SIGNED, STAMPED OR SEALED AS INSTRUMENTS OF SERVICE AND THE INTELLECTUAL PROPERTY IS DOCUMENTED BY THE CITY ARCHITECT DEPARTMENT. WHETHER THE OBJECT FOR WHICH THEY ARE MADE IS REGISTERED OR NOT, IT SHALL BE UNLAWFUL FOR ANY PERSON, WITHOUT THE CONSENT OF THE AUTHOR OR HIS SUCCESSORS TO DUPLICATE OR TO MAKE COPIES OF SAID DOCUMENTS FOR USE IN THE REPRODUCTION OF SAID DOCUMENTS OR FOR OTHER PURPOSES OR OTHERWISE, WITH THE EXCEPTED PARTS THEREIN.</p>	<p>RECOMMENDING APPROVAL</p> <p><b>AR. LUCILLE H. CHUA, fusp, piep</b> CITY ARCHITECT</p>	<p>APPROVED BY:</p> <p><b>HON. MA. JOSEFINA G. BELMONTE</b> MAYOR</p>	<p>PROJECT TITLE:</p> <p><b>SUPPLY &amp; INSTALLATION OF CHINESE ORNAMENTS AT BANAWA AVENUE</b></p> <p>LOCATION: BARANGAY SIENNA, QUEZON CITY</p>	<p>SHEET CONTENTS:</p> <p>LAMP POST DETAIL DRAGON METAL SHEET DECOR DETAILS</p>	<p>PROJECT NO.:</p> <p>DATE: January 2024 DRAWN BY: Ar. R.B.C / Ar. M.K.K.A DESIGNED BY: Ar. A.C.S.B / Ar. M.L.T.D. CHECKED BY: Ar. V.C.L / Ar. G.T.Q.</p>	<p>SHEET NO.:</p> <p><b>AR-05</b></p>
		<p>REPUBLIC OF THE PHILIPPINES</p>		<p>QUEZON CITY</p>			

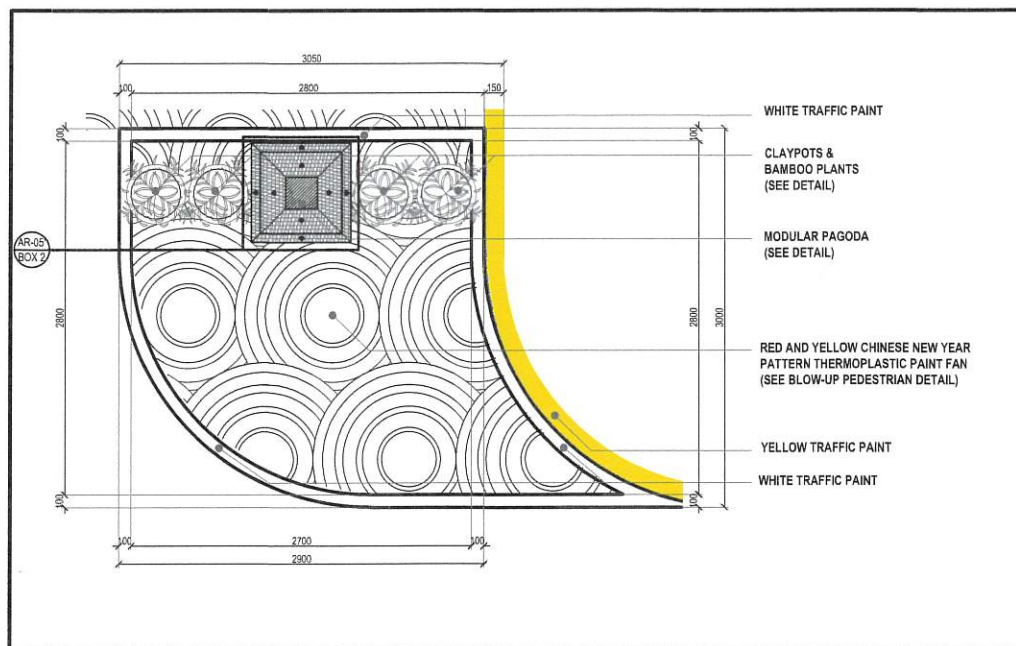

**1 SIDEWALK CORNER EXTENSION TYPE 1 - TYPICAL** SCALE 1:30 M

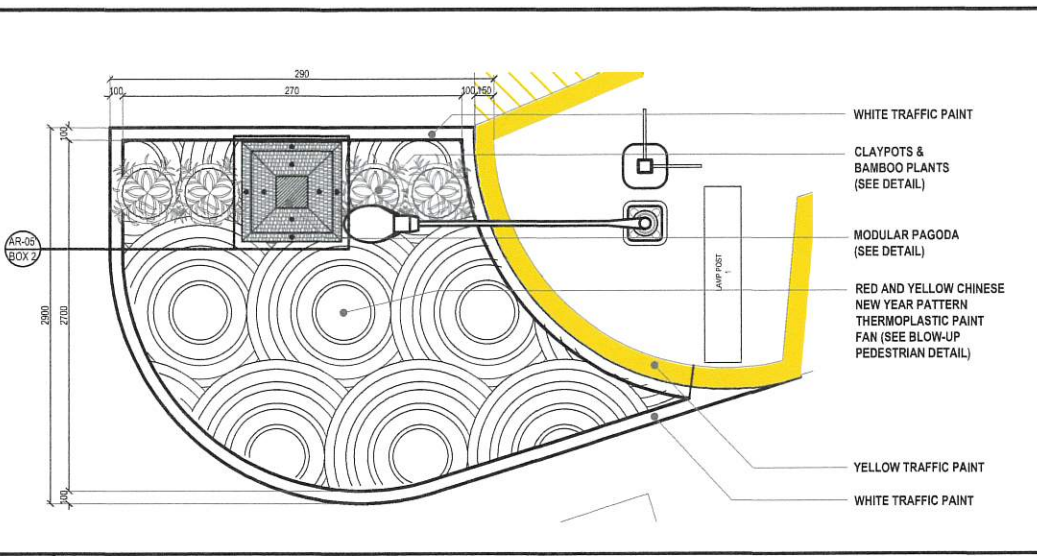

**2 SIDEWALK CORNER EXTENSION TYPE 2** SCALE 1:30 M

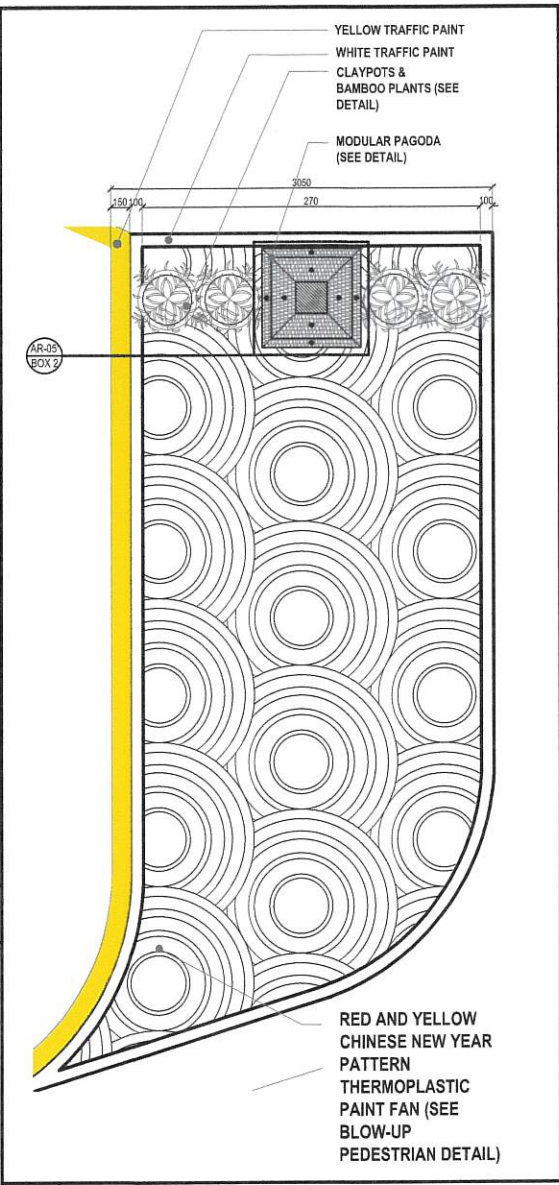

**3 SIDEWALK CORNER EXTENSION TYPE 3**

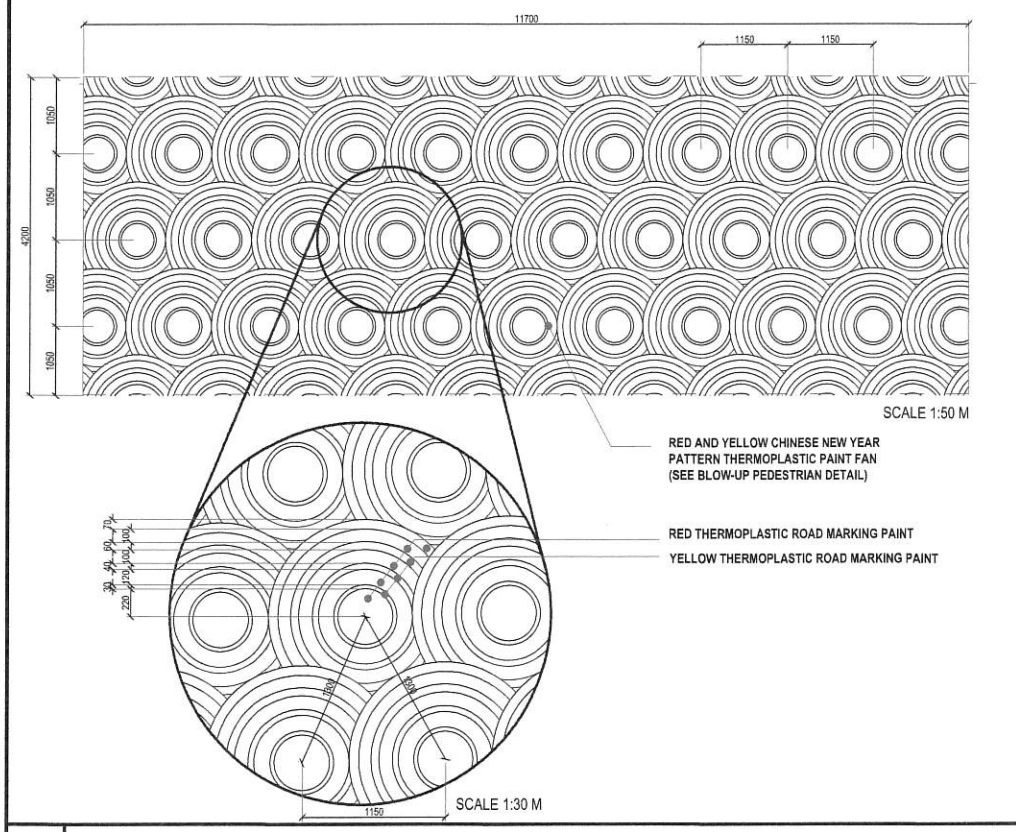

**4 PEDESTRIAN DETAIL** SCALE 1:30 M

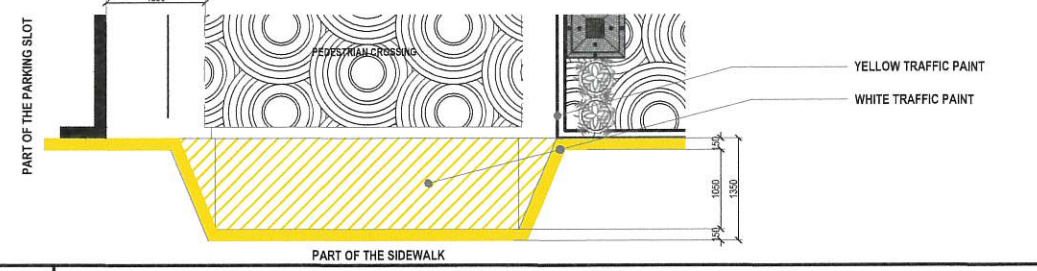

**5 PEDESTRIAN RAMP DETAIL** SCALE 1:50 M

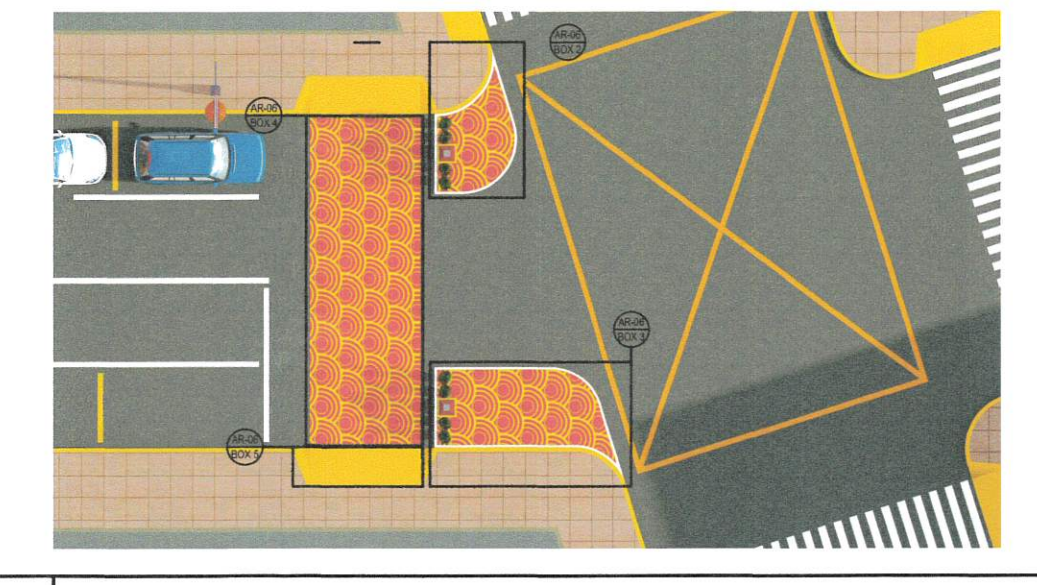

**6 KEY PLAN**

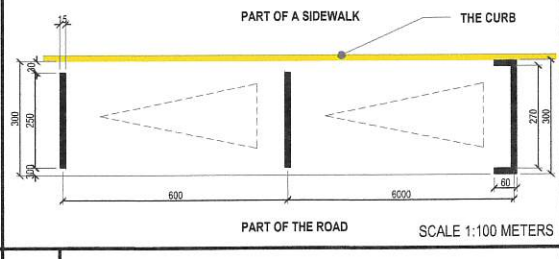

**7 PARKING SLOT MARKINGS** SCALE 1:100 METERS

<p>Republika ng Pilipinas Lungsod ng Quezon <b>CITY ARCHITECT DEPARTMENT</b> 5F CIVIC CENTER - D (BRO. Bldg), QUEZON CITY HALL COMPOUND, ELLIPTICAL ROAD, DILIMAN, QUEZON CITY</p>	<p>PROVISO: DRAWING AND SPECIFICATIONS SHALL BE SIGNED, STAMPED OR SEALED AS INSTRUMENTS OF SERVICE AND THE INTELLECTUAL PROPERTIES AND DOCUMENTS OF THE CITY ARCHITECT DEPARTMENT, WHETHER THE OBJECT FOR WHICH THEY ARE MADE IS REGISTERED OR NOT, IT SHALL BE UNLAWFUL FOR ANY PERSON, WITHOUT THE CONSENT OF THE ARCHITECT, TO MAKE COPIES OF SAID DOCUMENTS FOR USE IN THE REPRODUCTION OF ANY OTHER PROJECTS OR BUILDINGS, WHETHER EXECUTED PARTLY OR IN WHOLE.</p>	<p>RECOMMENDING APPROVAL</p> <p><b>AR. LUCILLE H. CHUA, fup, piep</b> CITY ARCHITECT</p>	<p>APPROVED BY:</p> <p><b>HON. MA. JOSEFINA G. BELMONTE</b> MAYOR</p>	<p>PROJECT TITLE:</p> <p><b>SUPPLY &amp; INSTALLATION OF CHINESE ORNAMENTS AT BANAWA AVENUE</b></p> <p>LOCATION: BARANGAY SIENNA, QUEZON CITY</p>	<p>SHEET CONTENTS:</p> <p>SIDEWALK CORNER EXTENSION TYPE 1 - TYPICAL SIDEWALK CORNER EXTENSION TYPE 2 SIDEWALK CORNER EXTENSION TYPE 3 PEDESTRIAN DETAIL PEDESTRIAN RAMP DETAIL KEYPLAN PARKINGS FOR MARKINGS</p>	<p>PROJECT NO.:</p> <p>DATE: January 2024 DRAWN BY: Ar. R.B.C. / Ar. M.K.K.A. DESIGNED BY: Ar. A.C.S.B. / Ar. M.L.T.D.R. CHECKED BY: Ar. V.C.L.J. / Ar. G.T.Q.</p>	<p>SHEET NO.:</p> <p><b>AR-06</b></p>
		<p>REPUBLIC OF THE PHILIPPINES</p>					

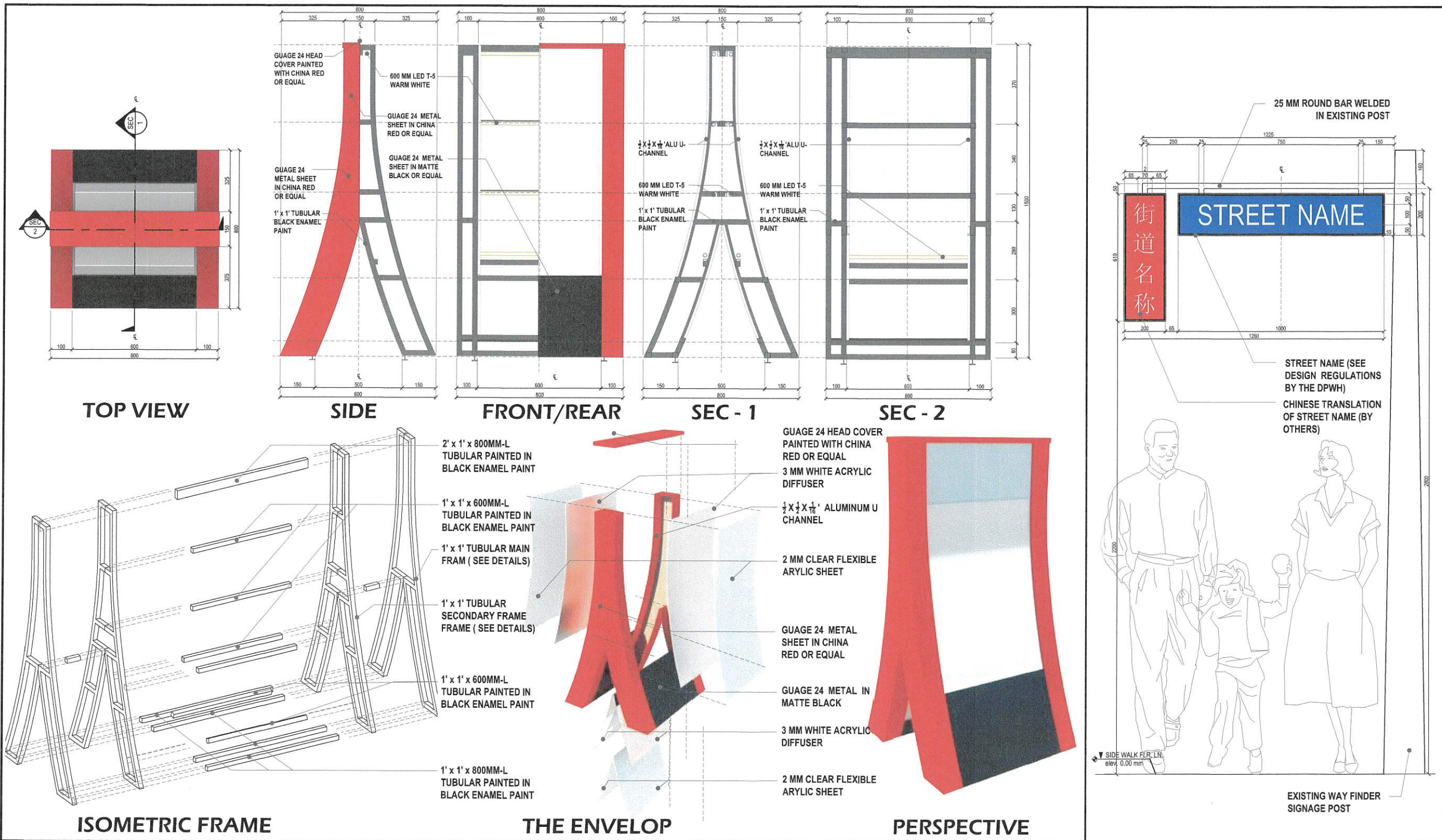

**1 WAY FINDER DETAILS**

**2 STREET WAY FINDER SIGNAGE**

SCALE 1:10 METERS

SCALE 1:10 METERS

<p>Republika ng Pilipinas Lungsod ng Quezon <b>CITY ARCHITECT DEPARTMENT</b> 5F CIVIC CENTER - D (Bldg. 808), QUEZON CITY HALL COMPOUND, ELLIPTICAL ROAD, DILIMAN, QUEZON CITY</p>	<p>PROVISO:</p> <p><small>DRAWING AND SPECIFICATIONS MUST BE SIGNED BY A REGISTERED ARCHITECT. THE INSTRUMENTS OF SERVICE ARE THE INSTRUMENTS OF SERVICE AND DOCUMENTS OF THE CITY ARCHITECT DEPARTMENT. THE ARCHITECT'S LIABILITY IS LIMITED TO THE SCOPE OF THE INSTRUMENTS OF SERVICE AND DOCUMENTS. NO LIABILITY SHALL BE INCURRED FOR ANY PERSON, WITHOUT THE CONSENT OF THE ARCHITECT, WHO USES OR REPRODUCES ANY INSTRUMENTS OF SERVICE OR DOCUMENTS FOR USE IN THE EXECUTION OF AND FOR OTHER PROJECTS OR BUILDINGS, WHETHER REGISTERED OR NOT.</small></p>	<p>RECOMMENDING APPROVAL</p> <p><b>AR. LUCILLE H. CHU, fuap, piep</b> CITY ARCHITECT</p>	<p>APPROVED BY:</p> <p><b>HON. MA. JOSEFINA G. BELMONTE</b> MAYOR</p>	<p>PROJECT TITLE:</p> <p><b>SUPPLY &amp; INSTALLATION OF CHINESE ORNAMENTS AT BANAWA AVENUE</b></p> <p>LOCATION: BARANGAY SIENNA, QUEZON CITY</p>	<p>SHEET CONTENTS:</p> <p>WAY FINDER DETAILS STREET WAY FINDER SIGNAGE</p>	<p>PROJECT NO.:</p> <p>DATE: January 2024</p> <p>DRAWN BY: Ar. R.B.C / Ar. M.K.K.A</p> <p>DESIGNED BY: Ar. A.C.S.B / Ar. M.L.T.D.L</p> <p>CHECKED BY: Ar. V.G.L / Ar. G.T.Q</p>	<p>SHEET NO.:</p> <p><b>AR-07</b></p>